



SOUNDSCAPES® BAFFLES CURVES

Assembly and Installation Instructions

DO NOT REMOVE BAFFLES FROM THE CARTON UNTIL YOU HAVE READ THESE INSTRUCTIONS IN THEIR ENTIRETY.

1. GENERAL

1.1 Product Description

SOUNDSCAPES® Baffles Curves are vertical, acoustical fibreglass panels designed to be suspended either individually from aircraft cables or in a group configuration from PeakForm™ Prelude™ XL 24mm Suspension Grid.

1.2 Materials and Finishes

SOUNDSCAPES Baffles Curves are made from fibreglass and finished on both sides with an acoustically transparent, durable painted scrim. Edges are factory painted to suit.

There are color options for the finished Baffles. Field painting will void the product warranty.

1.3 Design Consideration for Sag

SOUNDSCAPES Baffles Curves might exhibit a natural bow that may be noticeable when installed 50mm or less apart, end to end. Deflection up to 4mm has been documented in some cases.

NOTE: Do not butt Baffles end to end, but ensure a minimum gap of 50mm.

1.3.1 Precautionary Measures:

During the installation, be certain that the work site is well ventilated and avoid breathing dust. If high dust levels are anticipated during installation such as with the use of power tools, use an appropriate NIOSH designated dust respirator. Avoid contact with skin or eyes. Wear long-sleeve, loose fitting clothes, gloves, and eye protection.

1.3.2 First Aid Measures: If contact occurs flush eyes and skin irritation with plenty of water for at least 15 minutes and remove contaminated clothing. After installing material, wash with warm water and mild soap. Wash work clothes separately from other clothing. Rinse washer thoroughly. Refer to Armstrong Ceilings MSDS (which includes information on established occupational exposure limits) which are available from Armstrong Ceilings or your employer.

1.4 Storage and Handling

The Baffles shall be stored in a dry interior location and shall remain in their original cartons prior to installation to avoid damage. The cartons shall be stored in a flat, horizontal position. **The Baffles should not be removed from the carton until the suspension system is installed.** Proper care should be taken when handling to avoid damage and soiling. White cotton or latex gloves are recommended for handling.

1.5 Temperature During Installation

Baffles can be installed where the temperature is between 4°C and 49°C. Baffles cannot be used in exterior applications, where standing water is present, or where moisture will come in direct contact with the Baffles.

1.6 Fire Performance

SOUNDSCAPES® Baffles Curves may obstruct or skew the existing or planned fire sprinkler water distribution pattern, or possibly delay the activation of the fire sprinkler or fire detection system. Designers and installers are advised to consult a fire protection engineer.

1.7 Before You Start

All material delivered to site should be checked for damage, unopened and original packages.

All materials to be kept dry and protected from the elements.

1.8 Determine Baffle Location & Direction

SOUNDSCAPES Baffles Curves to be suspended as per specification and drawings. The drawing supplied by the builder will show the Baffle direction required.

2. INSTALLATION

2.1 Suspension Systems

There are three types of suspension options for use with SOUNDSCAPES Baffles Curves. They can be suspended individually from the deck with aircraft cable, or in groups from either PeakForm™ Prelude™ XL 24mm Grid or Unigridd™ Suspension Channel.

2.2 General

Baffles cannot be used to support any other material.

Baffles may require two people to install and align.

The suspension system chosen must be fastened to the structure in accordance with building code in your area.

SOUNDSCAPES Baffles Curves are factory fitted with embedded Spiral Anchor Clips along the top edge, for connection to either Aircraft Cable Suspension Hangers (for "single" installation) or to the Group Hanging Kit. See following illustrations.

Here are the dimensions and locations of the spiral anchor clips:

Dimensions

Panel item CS5163WH: 1200 x 400 x 40mm

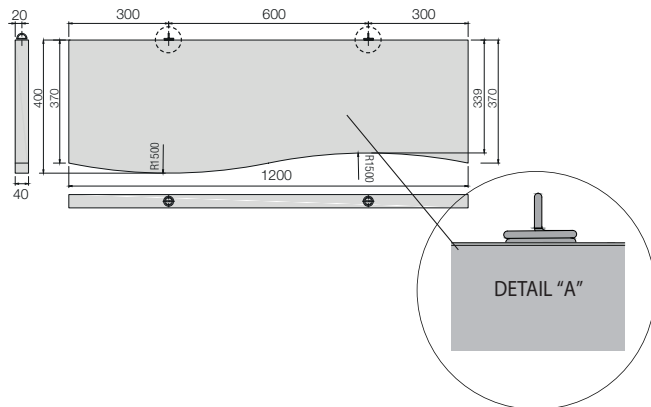

Panel item CS5164WH: 1800 x 400 x 40mm

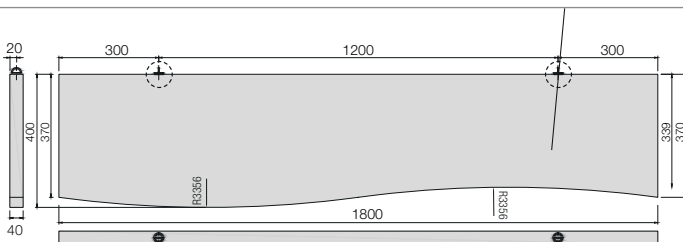

Hanging points are as per illustration above.

2.3 Single Baffle Suspension

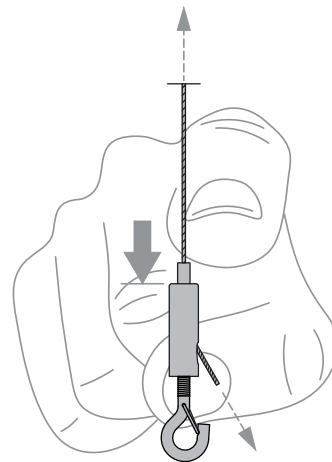
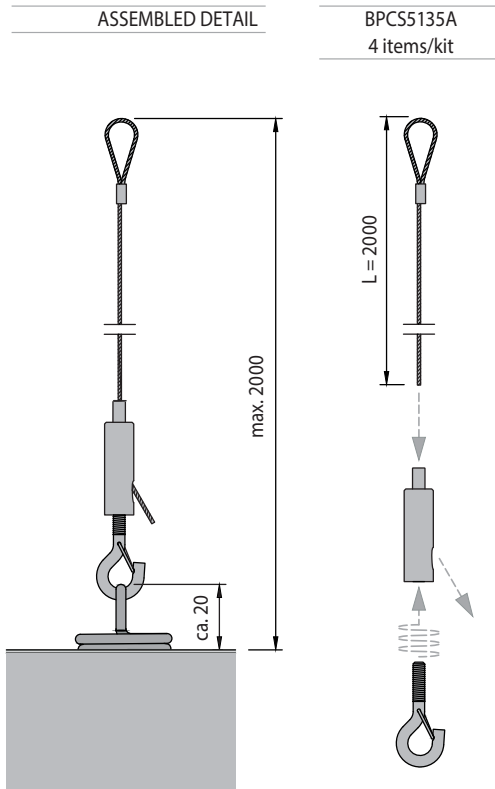

IMPORTANT SAFETY AND QUALITY NOTE: Do not allow any portion of wire or aircraft cable to drop below the top of a Baffle while adjusting final height. To do so could cause injury to the installer or scratch damage to the edge of the Baffle.

After the panel height is correct, cutoff excess cable leaving about 25mm remaining out the cable adjuster.

2.4 Baffle Hanging Kit – Independent Suspension

SOUNDSCAPES Baffles Curves can be independently suspended using Aircraft Cables and "quick release" Adjusters (Hanging Kit BPCS5135A).

1. Determine the location to hang the Baffles.
2. Fasten appropriate anchor to the structure. You must have a hole to loop the Aircraft Cable through on the anchor.
3. For each suspension point – Insert an aircraft cable into the top of the Gripper Cable Adjuster.
4. Insert the Gripper Hook into the bottom of the Cable Adjuster.
5. Attach Gripper bottom end assembly to Spiral Anchor Clips.
6. Gently pull the cable through the Cable Adjuster until all the slack is removed
7. To release the cable, take all weight off the Adjuster, push the release mechanism, and simply slide the cable out as needed.
8. Level the Baffle and trim the Aircraft Cable at the desired length.

2.5 Group Baffle Installation – Option 1: Installed on PeakForm™ Prelude™ XL 24mm Main Runner

PeakForm™ Prelude™ XL Main Runners to be installed as per Typical Grid Layout Drawings as follows. Refer Installation Instructions for PeakForm grid as required.

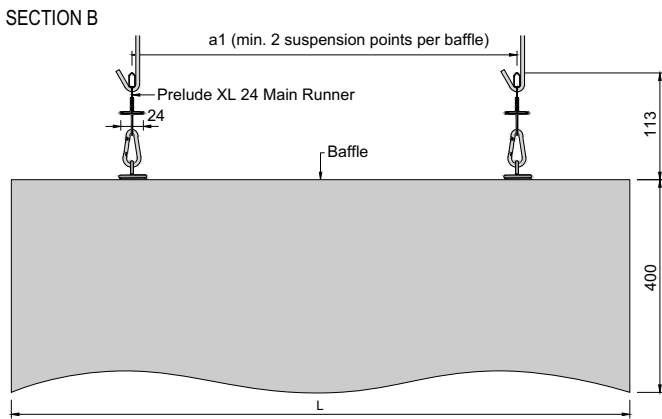
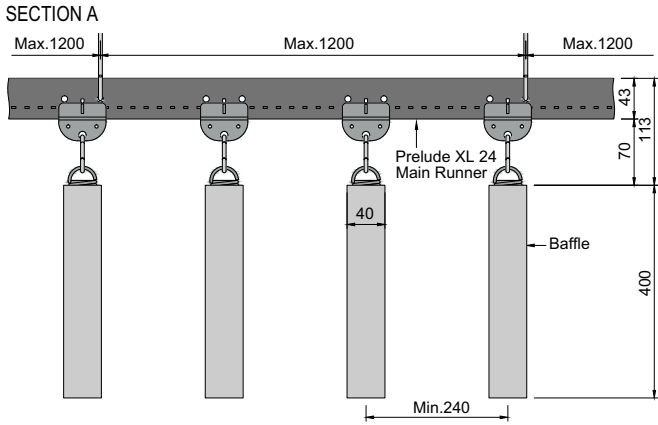

TYPICAL GRID LAYOUT – For either Prelude XL Grid or Unigrd Channels

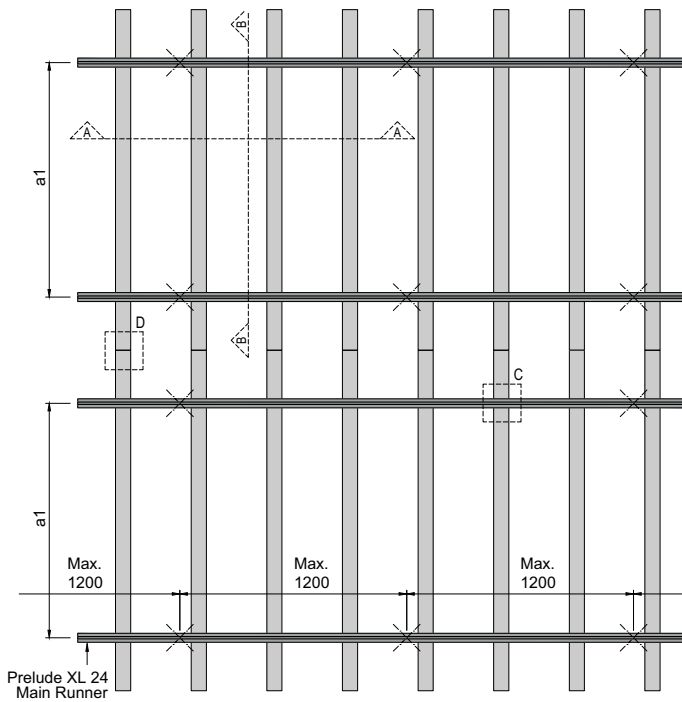

- a1 MAX DISTANCE BETWEEN PRELUDE XL MAIN RUNNERS / UNIGRID™ CHANNELS
 - = 600mm for Baffle item CS5163WH (with 2 suspension points)
 - = 1200mm for Baffle item CS5164WH (with 2 suspension points)
- L Baffle Length: 1200mm for Baffle item CS5163WH and 1800mm for Baffle item CS5164WH

2.6 Baffle Hanger Kit For Prelude Grid – Group Installation

DETAIL C HANGER KIT INSTALLATION

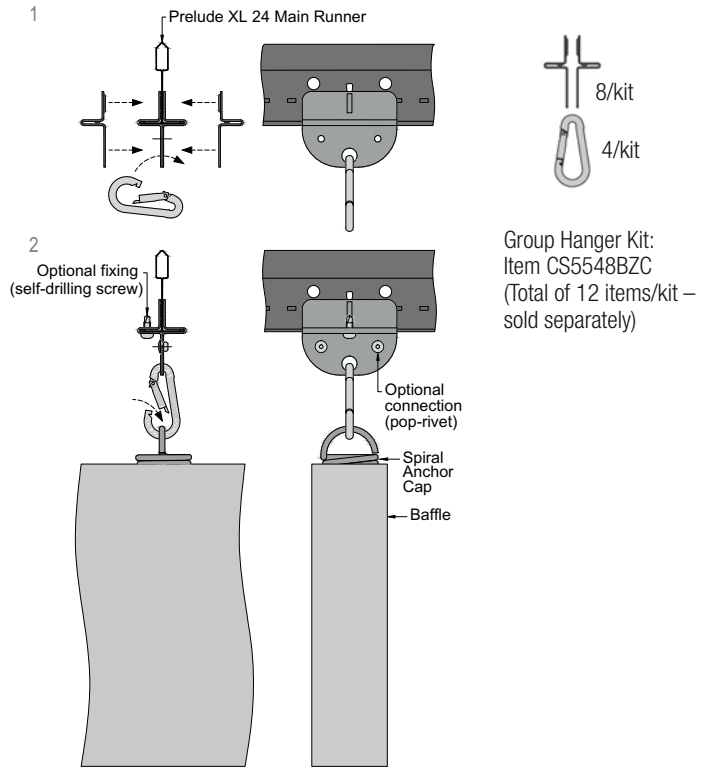

2.7 Group Baffle Installation – Option 2: Installed on Unigrig™ Suspension Channel

Unigrig™ Channels to be installed as per Typical Grid Layout Drawing. Refer Installation Instructions for Unigrig™ Suspension Channel as required.

SECTION A WITH SUSPENSION OPTION 1

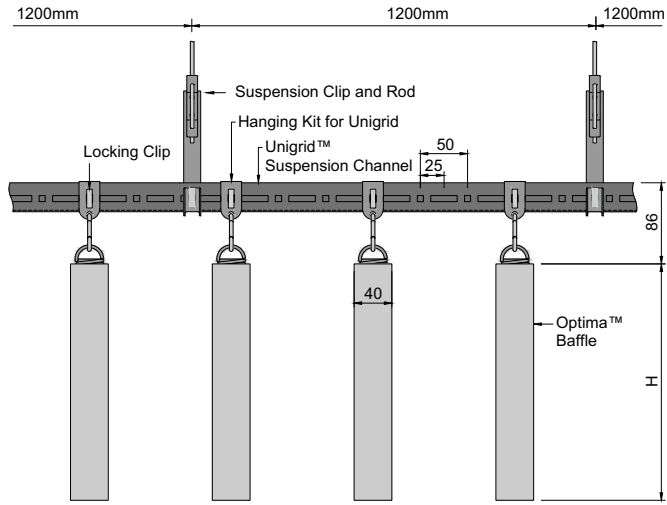

SECTION B WITH SUSPENSION OPTION 2

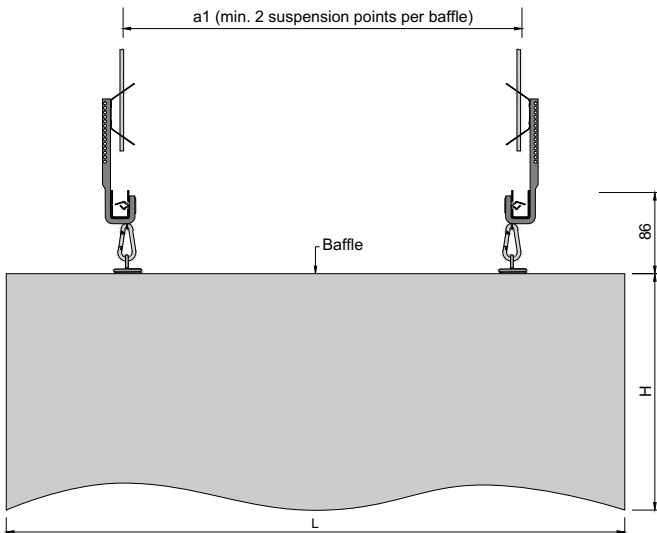

2.8 Baffle Hanger Kit For Unigrig – Group Installation

DETAIL C HANGER KIT INSTALLATION

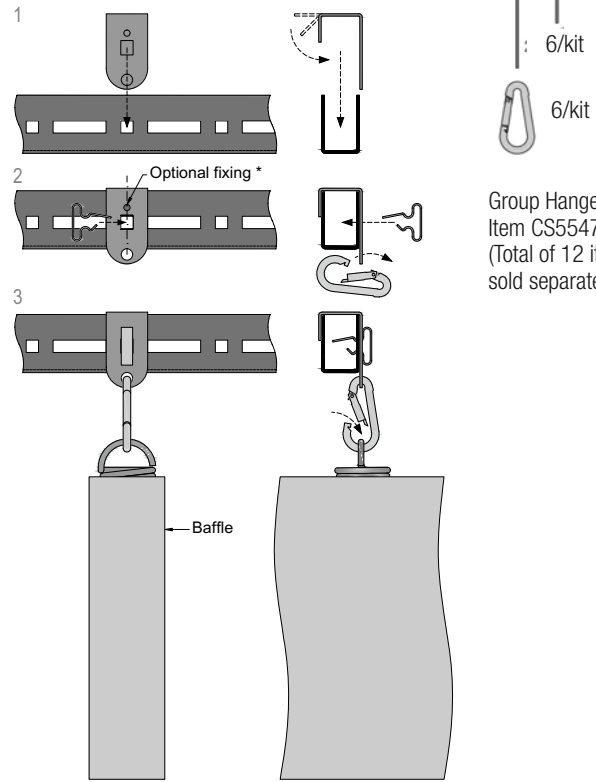

Group Hanger Kit:
Item CS5547BZC
(Total of 12 items/kit –
sold separately)

3. BAFFLE PENETRATIONS

The Baffle cannot be field cut for penetrations such as lighting or sprinklers.

4. CLEANING

Use a clean, dry, soft white cloth to wipe off any dirt or finger prints. Regular light dusting of the top side of the Baffle is recommended.

MORE INFORMATION

For complete technical information, detail drawings, CAD design assistance, installation information and many other technical services, call your local Armstrong Ceilings representative.

For the latest product selection and specification data, visit armstrongceilings.com.au

Armstrong, the Global Leader in Acoustic Ceilings

NSW/ACT

Armstrong World Industries Pty. Ltd.
Unit 4, 1 Basalt Road,
Pemulwuy NSW 2145

Telephone (02) 9748 1588
Facsimile (02) 9748 7244

QLD/NT

Armstrong World Industries Pty. Ltd.
6 Barrinia Street,
Slacks Creek QLD 4127

Telephone (07) 3809 5565
Facsimile (07) 3809 5507

WA

Ceiling Manufacturers of Australia Pty. Ltd.
5 Irvine Street,
Bayswater WA 6053

Telephone (08) 9271 0777
Facsimile (08) 9272 2801

VIC/TAS

Armstrong World Industries Pty. Ltd.
Unit 1, 88 Henderson Road,
Rowville VIC 3178

Telephone (03) 8706 4000
Facsimile (03) 8706 4040

SA

Total Building Systems Pty. Ltd.
160 Grand Junction Road,
Blair Athol SA 5084

Telephone (08) 7325 7555
Facsimile (08) 7325 7566

New Zealand

Forman Building Systems Ltd.
20 Vestey Drive, Mt Wellington ,
Auckland 1060

Telephone 64-9-276 4000
Facsimile 64-9-276 4141

www.armstrongceilings.com.au
scentre@armstrongceilings.com

Printed on Zanders Mega Recycled paper
AWP0318

Inspiring Great Spaces® is a Trademark of AFI Licensing LLC, All other trademarks are property of AWI Licensing LLC or affiliates and registered in the U.S. and/or other countries.
©2018 AWI Licensing LLC.

Inspiring Great Spaces®

Armstrong®
CEILING SOLUTIONS